

DATE:	CLIENT:	FIXTURE:	QUANTITY:
-------	---------	----------	-----------

TITAN HB

LED HIGH BAY

Industrial, Commercial, Warehouse, Storage, Recreational Facilities, and Arena applications



FEATURES / SPECIFICATIONS

FIXTURE

- Aluminum construction
- Polycarbonate protective lens
- Damp Rated
- Driver accessible drawer
- Natatorium option

EFFICACY

- LED 151 lpw | Delivered 120 lpw

COLOR RENDERING INDEX

- CRI 86

LUMEN MAINTENANCE

- 200,000+ life hours (L70)

POWER CONSUMPTION

- 80W / 120W / 160W / 240W / 320W

VOLTAGE

- 120/277V | 347/480V

CONTROLS

- 0-10V Dimming
- WiFi Dimmable
- Occupancy Sensor

COLOR TEMPERATURE

- 3000K / 3500K / 4000K / 5000K

OPERATING TEMPERATURE

- -25°C to +40°C
- -25°C to +55°C (option)

CERTIFICATIONS

- DLC Listed
- cULus listed

WARRANTY

- 10 Year Comprehensive Warranty

MADE IN CANADA

PERFORMANCE

MODEL	Input Watts	Lm/W	Delivered Lumens	Voltage
TITANHB 80	81.5	117.9	9,609	120/277 347/480
TITANHB 120	120.5	120.6	14,528	120/277 347/480
TITANHB 160	159	126.1	20,048	120/277 347/480
TITANHB 240	240.8	120.4	29,002	120/277 347/480
TITANHB 320	318	119.2	37,912	120/277 347/480



Not all products are qualified on the DLC QPL. To view our DLC qualified products, please consult the DLC Qualified Products List at www.designlights.org/qpl.

DIMENSIONS

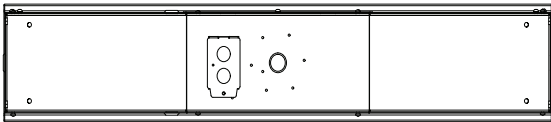

Side

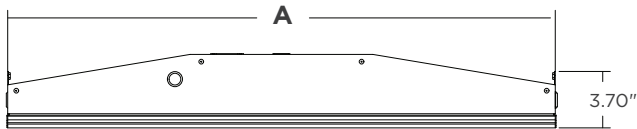

Top

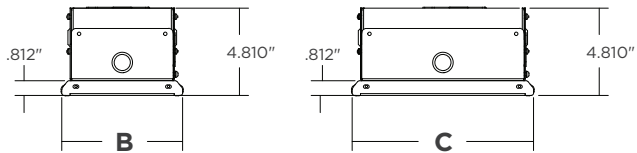

Side



Front

MODEL	A - Nominal Length	B - Width	C - Width
TITANHB 80	24"	6.654"	•
TITANHB 120	36"	6.654"	•
TITANHB 160	47.5"	6.654"	•
TITANHB 240	36"	•	12.60"
TITANHB 320	47.5"	•	12.60"

ORDERING OPTIONS

MODEL	WATTS	COLOR TEMP	VOLTAGE	LENS	FINISH
TITANHB	80	3K - 3000K	U - 120/277V	FR - Frosted	WH - White
	120	35K - 3500K	H - 347/480V	CL - Clear	CU - Custom
	160	4K - 4000K		CLG - Clear Glass	
	240	5K - 5000K			
	320				

MOUNTING

V - V Hook	MS3-1/2W - Mounting Stem 1/2" IPS (7/8" O.D.) 3' long threaded at both ends
JC72 - Jack Chain Set 4 X 72" with "S" hooks included	MS4-1/2W - Mounting Stem 1/2" IPS (7/8" O.D.) 4' long threaded at both ends
JC96 - Jack Chain Set 4 X 96" with "S" hooks included	MS6-1/2W - Mounting Stem 1/2" IPS (7/8" O.D.) 6' long threaded at both ends
JC144 - Jack Chain Set 4 X 144" with "S" hooks included	MS8-1/2W - Mounting Stem 1/2" IPS (7/8" O.D.) 8' long threaded at both ends
ACY120 - Aircraft Cable 120" W/Y Toggles & Adjusters	1/2 NPT - Diecast Mounting Plate with 1/2" NPT
ACY200 - Aircraft Cable 200" W/Y Toggles & Adjusters	3/4 NPT - Diecast Mounting Plate with 3/4" NPT
	IND - Indirect-Uplight mounting bracket
	TG - T Grid (Kit)

WIRING	ACCESSORIES	PLUG
BFC - Black Flexible Cord	N - None	N - None
WFC - White Flexible Cord	OCC - Occupancy Sensor (on/off)*	* SEE PLUG OPTIONS
	WC - Wireless Controls*	
	BLD - Bi Level Dimming (100%/10%)	
	GCC - Gasketed and Conformal Coated	
	DA - Dimming Wire Accessible	
	10kV - 10kV Surge Protection	

NOTE:

- **TG** - See TitanHB 80 and TitanHB 160 with Recessed Kit Data Sheet (www.delviro.com) or consult factory
- **TitanHB Natatorium** includes conformal coated boards and gasketing for damp and chlorine rated environments.
- **WC** - Please consult factory

SAMPLE PRODUCT CONFIGURATION: TITANHB - 80 - 5K - U - FR - WH- V - BFC - OCC - N

TITANHB									
MODEL	WATTS	COLOR TEMP	VOLTAGE	LENS	FINISH	MOUNTING	WIRING	ACCESSORIES	PLUG

PLUG OPTIONS

5-15P - 125V 15A T-Slot Plug	6-20P - 250V AC 20A Plug	24-20P - 347V AV 20A 3W/2P Plug NEMA 24-20
L5-15P - 125V 15A Locking Plug	L6-20P - 250V 20A Locking Plug	L24-20P - 347V 20A Locking Plug
5-20P - 125V AC 20A T-Slot Plug	7-15P - 277V 15A 3W/2P NEMA 7-15 Plug	24-15P - 347V AC 15A 3W/2 Plug NEMA 24-15
L5-20P - 125V 20A Locking Plug	L7-15P - 277V 15A Locking Plug	
6-15P - 250V AC 15A 3W/2P Plug NEMA 6-15	7-20P - 277V AC 20A Plug	
L6-15P - 250V 15A Locking Plug	L7-20P - 277V 20A Locking Plug	

© Delviro Energy Specifications are subject to change without notice