

Featuring VirtualSource Reflectors

# 8" Horizontal VirtualBaffle® Two Lamp Downlights CFCB818QHEB CFCB826QHEB

Two 18W or Two 26W Quad  
4-Pin Lamps  
120V to 277V and 347V  
Non-IC Rated

DATE: \_\_\_\_\_ TYPE: \_\_\_\_\_

FIRM NAME: \_\_\_\_\_

PROJECT: \_\_\_\_\_



Ceiling Cutout: 8 1/4"  
Maximum Ceiling Thickness: 1 1/4"  
For conversion to millimeters,  
multiply by 25.4  
Not To Scale

### APPLICATIONS:

Virtual Baffle luminaires feature downlight and wall wash distributions with excellent brightness and glare control in a shallow plenum housing. Suitable for use in a wide variety of commercial applications including offices, lobbies, and retail projects where shallow plenum luminaires are required. The CFCB8 series is compatible with the Signos8 family of architectural elements.

### HOUSING:

One-piece galvanized 18-gauge cold rolled steel platform. Prewired J-box with snap-on cover for easy access.

### REFLECTOR:

360° rotatable Virtual Source® Cross Baffle allows perfect jobsite alignment. \* Available in specular clear, champagne gold, or white. \* Self trim standard. A painted white self trim option and American Matte (MFC) also available.

### BALLAST:

One (1) compact fluorescent Class 'P' electronic multi-volt (120V through 277V) ballast suitable for operating 18W or 26W Quad tube lamps. HPF and EOL protection standard. Accessible from below ceiling.

### LAMP/SOCKET:

Two injection molded sockets. Suitable for two 18W quad tube (G24q-2 base), or two 26W quad tube (G24q-3 base) compact fluorescent lamps. Lamps furnished by others or as option below.

### INSTALLATION:

Universal adjustable mounting brackets accommodate 1 1/2" or 3/4" lathing channel or 1/2" EMT (by others), or Prescolite 24" bar hangers (B24 or B6).

### LABELS:

UL listed or UL/CSA listed with CDN option for damp locations. Approved for through wiring  
Non-type IC and NYC approved

### LAMP INCLUDED OPTION:

Specify lamp type Q4 (Quad 4-pin) and temperature as shown below.

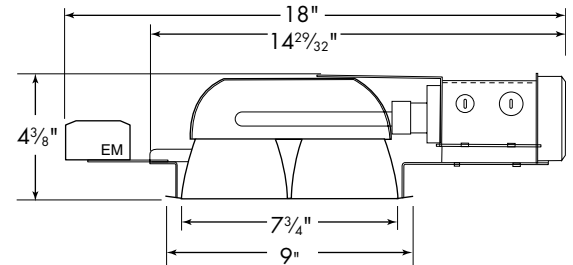
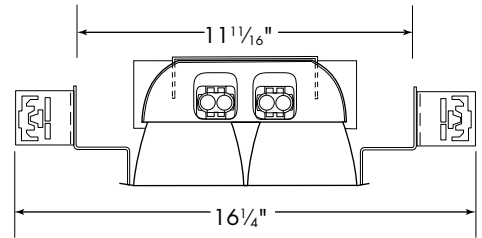

(Virtual Baffle shown above.)

### Virtual Baffle



CB Model

CATALOG NUMBER:

EXAMPLE: CFCB818QHEB STCB8ACG LP18Q430K B24

HOUSINGS	HOUSING OPTIONS	HOUSING OPTIONS	REFLECTORS	REFLECTOR FINISH	ACCESSORIES
<input type="checkbox"/> <b>CFCB818QHEB</b> 8", (2) 18W Quad tube, multi-volt electronic ballast <input type="checkbox"/> <b>CFCB826QHEB</b> 8", (2) 26W Quad tube, multi-volt electronic ballast	<input type="checkbox"/> <b>CDN</b> Canadian electrical code compliant ballast disconnect <input type="checkbox"/> <b>CDN 347V<sup>3</sup></b> Canadian electrical code compliant ballast disconnect <input type="checkbox"/> <b>DM</b> Electronic Analog Dimming Ballast to 3%, 4-wire, 0-10V (120V-277V) <input type="checkbox"/> <b>ECDM</b> Lutron EcoSystem or 3-wire line voltage dimming ballast (120-277V). Dims to 5%. <input type="checkbox"/> <b>7DM</b> Advance Mark 7 Dimming Ballast to 5%, 4-wire, 0-10V analog (120V-277V) (specify voltage/wattage) <input type="checkbox"/> <b>XDM</b> Advance Mark 10 Dimming Ballast to 5%, 2-wire, line voltage (specify supply voltage) <input type="checkbox"/> <b>2DM</b> Lutron Tu-Wire Dimming Ballast to 5%, 2-wire, line voltage (120 volt only) (specify wattage)	<input type="checkbox"/> <b>EM<sup>2,6</sup></b> Emergency battery pack with integral test switch and indicator light <input type="checkbox"/> <b>EMR<sup>6,7</sup></b> Emergency battery pack with remote test switch and indicator light <input type="checkbox"/> <b>FSDFA</b> Fuse kit installed at factory <input type="checkbox"/> <b>RIF1<sup>4,6</sup></b> Radio interference filter (single circuit) <input type="checkbox"/> <b>SMT<sup>6</sup></b> Philips Advance SmartMate® ballast <input type="checkbox"/> <b>SYL<sup>1</sup></b> Osram Sylvania Ballast (available only for standard EB option)	<input type="checkbox"/> <b>STCB8ACL</b> 8" clear Alzak Cross Baffle reflector <input type="checkbox"/> <b>STCB8ACG</b> 8" champagne gold Alzak Cross Baffle reflector <input type="checkbox"/> <b>STCB8AWH</b> 8" white cross baffle reflector with white flange	<input type="checkbox"/> <b>Blank</b> Specular <input type="checkbox"/> <b>SS<sup>5</sup></b> Semi-Specular <hr/> <b>REFLECTOR OPTIONS</b> <input type="checkbox"/> <b>L</b> Clear Glass Lens <input type="checkbox"/> <b>SL</b> Glass Prismatic Spread Lens <input type="checkbox"/> <b>WT</b> Painted white self-flange <input type="checkbox"/> <b>WW</b>	Wall wash reflector <input type="checkbox"/> <b>B24</b> Set of two (2) 24" bar hangers for T-bar ceilings <input type="checkbox"/> <b>B6</b> Set of two (2) bar hangers for ceiling joists up to 24" centers <input type="checkbox"/> <b>FSDFI</b> Fuse kit for field installation <hr/> <b>LAMP ACCESSORIES</b> <input type="checkbox"/> <b>LP</b> -wattage= 18 and 26 only -type= Q4 (Quad 4-pin) -temp= 27K, 30K, 35K, 41K (Kelvin) *Example: LP18Q441K Requires two lamps.

<sup>1</sup>Available for Osram Sylvania Quick 60+® Limited Warranty when used with Osram lamp(s). See www.prescolite.com for details.  
<sup>2</sup>Not available with lensed options  
<sup>3</sup>Dimming option not available in 347V  
<sup>4</sup>Contact Technical support  
<sup>5</sup>Not available for Champagne Gold with cross baffles  
<sup>6</sup>Not available for 347V  
<sup>7</sup>Remote mount test switch and indicator light for use with lensed trim.



In a continuing effort to offer the best product possible we reserve the right to change, without notice, specifications or materials that in our opinion will not alter the function of the product.  
 Web: [www.prescolite.com](http://www.prescolite.com) • Tech Support: (888) 777-4832

ARCH-CFL-030

# PHOTOMETRIC DATA

## Architektür - 6" Horizontal VirtualBaffle and TurboBaffle™ Downlights - CFCB8 Series

### BALLAST DATA

	18W Quad			26W Quad		
	120V	277V	347V	120V	277V	347V
Total Input Watts	38W	38W	36W	57W	57W	58W
Input Current (Amps)	0.32	0.14	0.11	0.48	0.21	0.17
Input Frequency in Hz	50/60	50/60	50/60	50/60	50/60	50/60
Power Factor	>97%	>97%	>97%	>97%	>97%	>97%
Ballast Factor	>98%	>98%	1	>98%	>98%	1
Total Harmonic Distortion	<10%	<10%	<10%	<10%	<10%	<10%
Total Harmonic Distortion	-18°C (0° F)	-18°C (0° F)	-18°C (0° F)	-18°C (0° F)	-18°C (0° F)	-18°C (0° F)

### LAMP DATA

	18W Quad	26W Quad
Rated Watts	18W Quad	26W Quad
Rated Lumens	1250	1800
Efficacy (LPW)	69	69
Rated Life	10,000 hrs.	10,000 hrs.
CRI	82	82
Min. Starting Temp.	0°F	0°F

### CFCB826QHEB-STCB8ACL Virtual Baffle

Lamp: Two 26W Quads  
Spacing Criteria: 0°=1.6  
90°=1.7  
Efficiency = 45.4 %

#### CANDLEPOWER SUMMARY

Angle	0°	45°	90°
0	1192	1192	1192
5	1242	1242	1233
10	1242	1276	1242
15	1216	1246	1196
25	997	1090	1086
35	853	896	790
45	380	354	308
55	34	30	21
65	0	0	0
75	0	0	0
85	0	0	0

#### CANDLEPOWER DISTRIBUTION

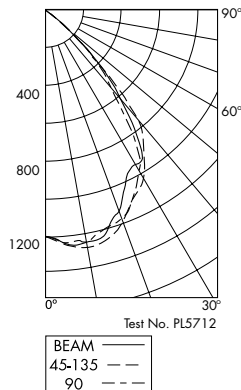

### CFCB826QHEB-STCB8ACL Virtual Baffle

Test No. PL5712

#### LUMINANCE DATA IN CANDELA/SQ. METER

Angle in Vertical	Average 0°	Average 45°	Average 90°
45°	9359	8869	9851
55°	0	439	801
65°	0	0	0
75°	0	0	0
85°	0	0	0

### CFCB826QHEB-STCB8ACL Virtual Baffle

Test No. PL5712

#### AVERAGE INITIAL FOOTCANDLES

Multiple Units (Square Array)  
Ceiling 80% Wall 50% Floor 20%

26W Quads

SPACING	RCR1	RCR3	RCR7

CONTACT FACTORY FOR  
AVERAGE INITIAL FOOTCANDLES

### NOTES

Ⓢ vs Denotes a Virtual Source reflector.

Refer to [www.prescolite.com](http://www.prescolite.com) for additional photometric tests (IES Files).

**Note:** Use of horizontally-lamped open downlights with amalgam-based CFL lamps in air-handling plenums is not recommended because cool air flow over the lamps will result in reduced light output. Prescolite recommends vertical lamp downlights or use of the regressed lensed trim option for horizontal downlights in these applications to reduce this effect. Refer to Prescolite White Paper WPO003 at [www.prescolite.com](http://www.prescolite.com) for more information.



Web: [www.prescolite.com](http://www.prescolite.com) • Tech Support: (888) 777-4832

701 Millennium Blvd. • Greenville, SC 29607 U.S.A. • Phone (864) 678-1000  
Copyright ©2015 Prescolite, Inc., a division of Hubbell Lighting, Inc. All Rights Reserved  
Specifications subject to change without notice. • Printed in U.S.A. • ARCH-CFL-030 • 4/16/15



**HUBBELL**  
Lighting, Inc.